



Visitez Traxxas.com/manuals pour télécharger les instructions dans votre langue.
Visite la página Traxxas.com/manuals para descargar el instrucciones en su idioma.
Auf Traxxas.com/manuals, können Sie anleitung in Ihrer Sprache downloaden.

3-Volt Accessory Power Supply & Power Tap Installation Instructions

Covers Part #6588X

Kit contents:

- 3-volt accessory power supply
- Electronic speed control (ESC) power tap
- Power tap cover
- 3x10mm button-head cap screws (2)
- 2.6x8mm button-head cap screws (2)

Tools needed:

- 2.0mm hex wrench

Technical Specifications

Input Voltage	5.0 - 16.8 volts
Output Voltage	3 volts
Output Wattage	8.4 watts
Number of output connectors	2



CAUTION: RISK OF DAMAGE TO BATTERIES!

Do not attach the power tap to the battery connector. Attach to the electronic speed control (ESC) connector only. Always disconnect the battery from the ESC when not in use to prevent the possibility of over-discharge.



CAUTION: RISK OF DAMAGE TO ACCESSORIES!

Note the polarity and wire color on the pre-installed wires on the power tap. Ensure the polarity is correct during installation on the High-Current Connector: red (+) (positive), black (-) (negative).

3s and Smaller Vehicles

Important Note! Use the included power tap as the direct battery source for the accessory power supply. Do not connect to the accessory BEC power output on the ESC (if equipped). Connecting high-load accessories to the power supply while it is plugged directly into the ESC could overload the speed control's BEC circuit. This may cause the speed control to go into thermal protection mode or could cause damage to the speed control.

1 Install the accessory power supply on the chassis.

Power Input Connector
(to 2-pin male connector from power tap)

3x10mm BCS

3-volt Output Connectors
(for LED lights)

Note: Some models may use the inner mounting holes. If necessary, trim the case as shown to fit.

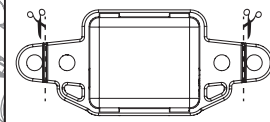

Rustler 4X4 shown. For installation on most other models, use Traxxas kits #6554 or #6555 (each sold separately). Visit Traxxas.com for additional information.

2

Attach the power tap to the High-Current Connector of the electronic speed control (ESC).

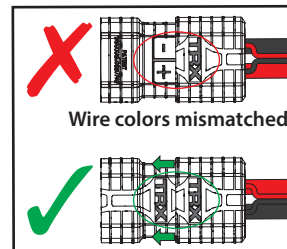
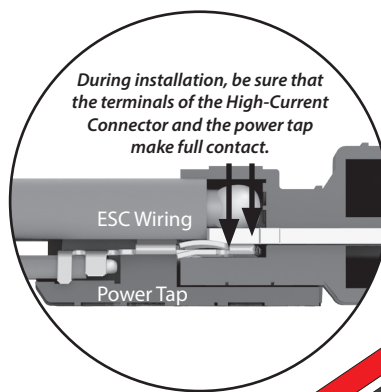

ESC Wiring

High-Current Connector

ESC Power Tap

3

Install the cover on the power tap.

2.6x8mm BCS (self-tapping)

ESC Power Tap Cover

ESC Wiring

If you have questions or need technical assistance, call Traxxas at

1-888-TRAXXAS

(1-888-872-9927) (U.S. residents only)

TRAXXAS.COM

Traxxas, 6250 Traxxas Way, McKinney, TX 75070, Phone: 972-549-3000, Fax: 972-549-3011, e-mail: support@Traxxas.com

HKC24008-R01 Rev 251031

4s and Larger Vehicles or Vehicles with Dual Battery Configurations

- 1 Install the accessory power supply on the chassis or vehicle body.

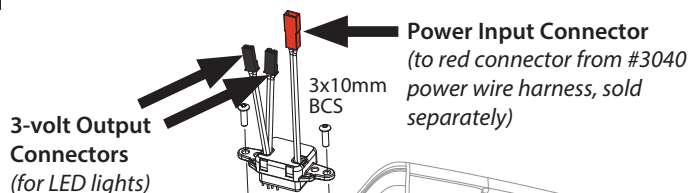

X-Monster body shown. The power supply may mount in different locations on other models or modifications may be required. Visit Traxxas.com for additional information.

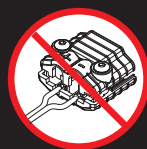

CAUTION

Burn hazard.
Hot wires.
Do not touch.

DO NOT install the included power tap on vehicles with dual battery configurations. Incorrect installation of the power tap on the High-Current Connector will cause one of the batteries to short circuit, damage the electronic speed control (ESC), and damage the batteries.

- 2 Plug the red male connector of the #3040 power wire harness into the power input connector from the accessory power supply. Plug the other end into any open channel on the receiver.

Note: If additional wire length is needed during installation, the #10959 extension harness (sold separately) can be used along with the #3040 power wire harness.

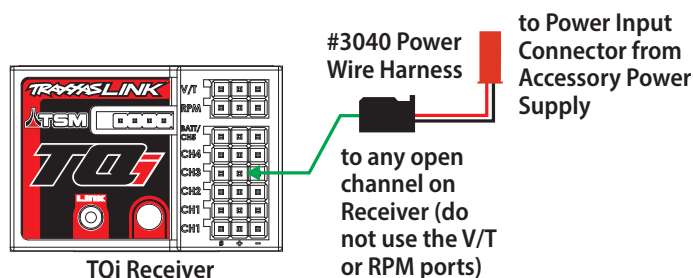

Limited Warranty Information

Traxxas electronic components are warranted to be free from defects in materials and workmanship for a period of 30 days from the date of purchase.

Limitations: Any and all warranty coverage does not cover replacement of parts and components damaged by abuse, neglect, improper or unreasonable use, crash damage, water or excessive moisture, chemical damage, improper or infrequent maintenance, accident, unauthorized alteration or modification or items that are considered consumable. Traxxas will not pay for the cost of shipping or transportation of a defective component to us.

Traxxas Lifetime Electronics Limited Warranty

After the expiration date of the warranty period, Traxxas will repair electronic components for a flat rate. Please visit Traxxas.com/support for a current schedule of warranty costs and fees. The covered repairs are limited to non-mechanical components that have NOT been subjected to abuse, misuse, or neglect. Products damaged by intentional abuse, misuse, or neglect may be subject to additional charges. Traxxas liability, in no case, shall be greater than the actual purchase price of this product. For replacement, product must be returned in brand new condition, with packaging and itemized sales receipt.



This device complies with FCC Part 15 & IC RSS-210 rules subject to the following conditions: 1) This device may not cause harmful interference, and 2) This device must accept all interference received, including interference that may cause undesired operation.